

NOTES ON ARRANGEMENT:

THIS SHEET SHOWS A SUGGESTED ARRANGEMENT FOR YOUR BOAT. IT HAS BEEN THOUGHT-OUT AND DEVELOPED AROUND OUR EXPERIENCE IN MOTOR YACHT CRUISING, BUT YOU MAY HAVE OTHER IDEAS YOU WOULD LIKE TO INCLUDE IN YOUR BOAT. CONTACT BRUCE ROBERTS DESIGN FOR INFORMATION ON CUSTOMIZING THE ARRANGEMENT TO SUIT YOUR REQUIREMENTS.

AS WITH ALL ARRANGEMENTS, IT IS A GOOD IDEA TO MOCK-UP THE ARRANGEMENT USING CHEAP PLYWOOD TO GET A FEEL FOR THE LAYOUT IN FULL SCALE. DOING THIS BEFORE CUTTING OUT YOUR GOOD JOINERWORK LUMBER WILL SAVE MONEY AND TIME!

Bruce Roberts design. Trawler Yacht kit			
DRAWING TITLE Roberts Voyager 55			
DATE OCT 1999	DRAWN BY HMM	SCALE 1 = 24 1/2"	SHEET # 1 AA
MAT'L STEEL	L.O.D. 55'-0"	L.W.L. 54'-4"	DRAFT 5'-0"
BEAM 17'-9"	DISPLACEMENT 91,500 LBS	POWER 150 - 200 hp	

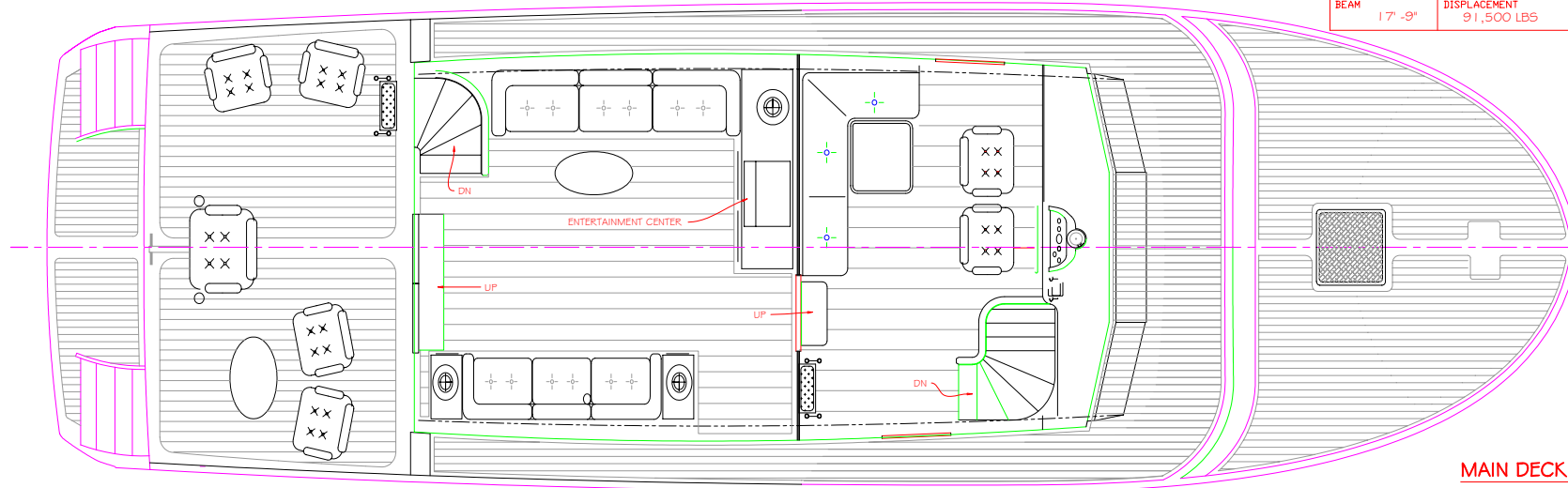

MAIN DECK ARRANGEMENT

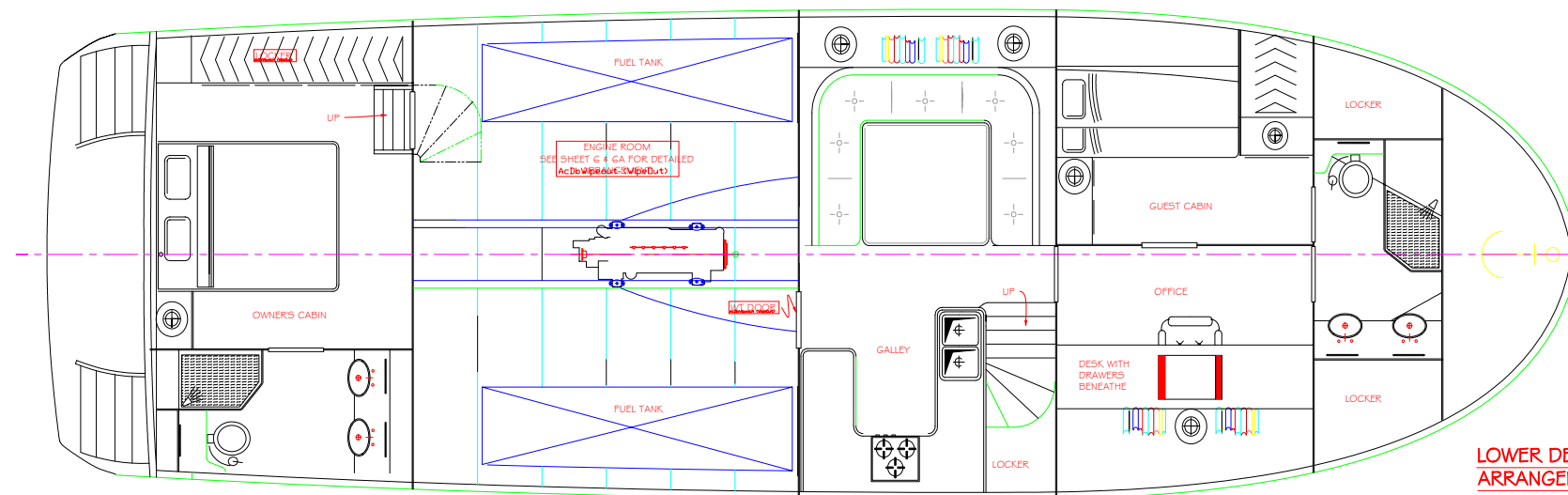

LOWER DECK ARRANGEMENT